

## Construction Advisory #2 Southbound I-15 Nighttime Closure

Please be advised that for two consecutive nights, beginning Tuesday, June 25, southbound I-15 will be closed from Mira Mesa Boulevard to Carroll Canyon Road from 11 p.m. to 5 a.m. During this time, a temporary wood and steel structure will be erected over the southbound I-15 lanes as crews continue to construct the Mira Mesa Direct Access Ramp (DAR). The Express Lanes will remain open for carpoolers and solo drivers with a FasTrak® account. Signs will be posted on the freeway in advance of the closure to alert drivers to the following detours:

**Southbound I-15 motorists:** Exit east on Mira Mesa Boulevard, then south on Black Mountain Road, on to I-15 south from Carroll Canyon Road. **Detour 1** (shown below).

**Eastbound Mira Mesa Boulevard motorists traveling to I-15 south:** Use Black Mountain Road and proceed with **Detour 1** (shown below). Or continue east on Mira Mesa Boulevard and proceed with **Detour 2** (shown below).

**Westbound Mira Mesa Boulevard motorists traveling to I-15 south:** Use Scripps Ranch Boulevard and proceed with **Detour 2** (shown below).

The Mira Mesa DAR along with the new Miramar College Transit Station, which is also under construction, will link to the I-15 Express Lanes via Hillery Drive. This will be the fifth DAR constructed along the I-15 Corridor and will support future Rapid Transit service beginning in summer of 2014. Construction of the DAR and transit station is scheduled to be complete next year.

### How to Stay Informed

Save yourself time and be prepared. Call or visit us online to learn about your travel options and plan your commute during construction.

▶ **I-15 Public Information Office:** (619) 668-3368

▶ **Website:**  
KeepSanDiegoMoving.com

 SANDAGREGION

 @SANDAG

@SDCaltrans

 SANDAGREGION

### Southbound I-15 Nighttime Freeway Closure

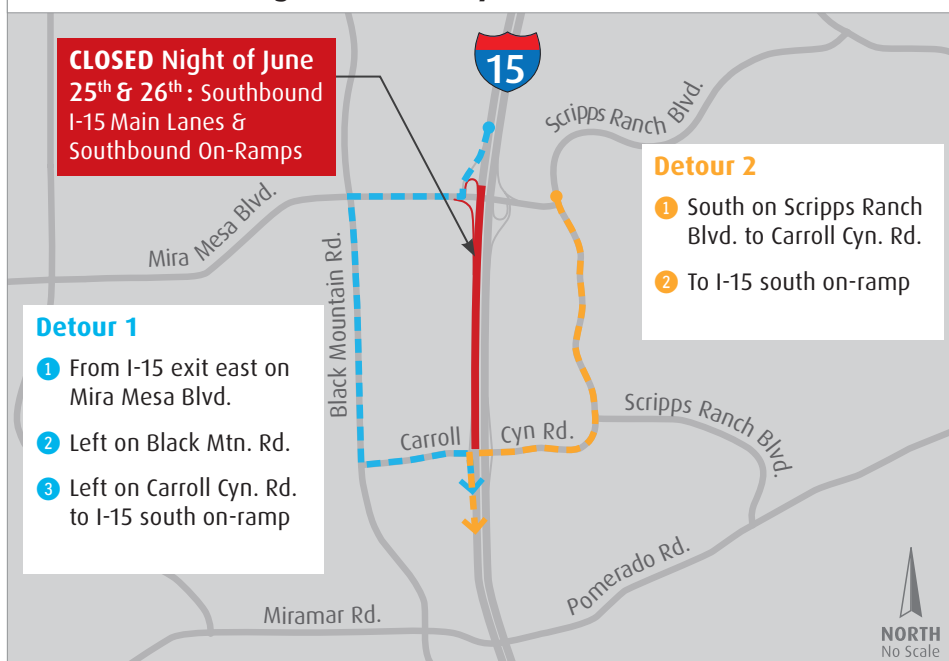

### Vicinity Map

